

**InEpilepsy**

Version 1.0.0

# **Artificial Intelligence Supported Mobile Software for Epilepsy Patients**

SMART POWER FOR YOUR LIFE COMFORT



# Table of Contents

## **1. Application – Install**

- 1.1 Download Steps
- 1.2 Application Login
- 1.3 Application Registration
- 1.4 App Permissions

## **2. Home Page**

- 2.1 Connecting the Device via Bluetooth
- 2.2 Overview
- 2.3 Navigation Tab Bar

## **3. Medication Reminder**

- 3.1 Overview
- 3.2 Adding Medication
- 3.3 Medicine Update

## **4. Contacts**

- 4.1 Overview
- 4.2 Adding Patient Relative

## **5. Records**

- 5.1 Overview
- 5.2 Adding Crisis

## **6. Settings**

- 6.1 Overview
- 6.2 Artificial Intelligence Training
- 6.3 Other Settings
- 6.4 Alert Settings
- 6.5 Change Password
- 6.6 Select Doctor
- 6.7 Backup
- 6.8 About
- 6.9 Whatsapp Support

## **7. Armband**

- 7.1 Overview

## **8. Patient's Contacts – Help Request**

- 8.1 Text Messages
- 8.2 Outgoing Call

## **9. Notifications**

- 9.1 Epileptic Status
- 9.2 Medication Reminder
- 9.3 Armband Disconnection

1.

# Application Install

## 1.1 Download Steps

## InEpilepsy Google Play Store Download

You can download the InEpilepsy application from the Google Play Store to your device for free.

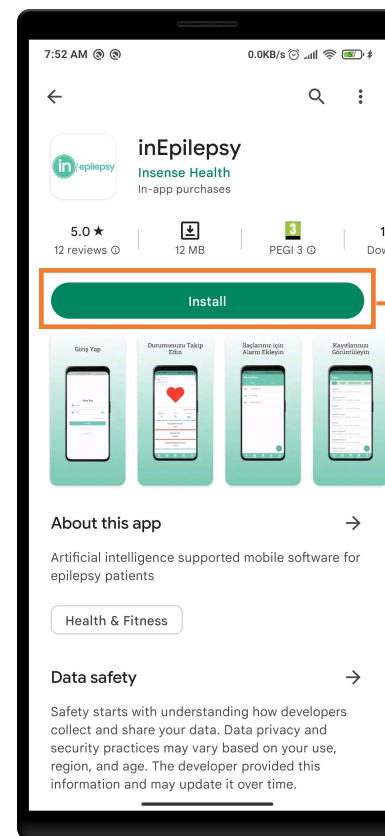

**Google Play Store**  
Search for the application by typing the keyword inEpilepsy and click the Install button to download it.

# 1.

## Application Install

### 1.2 Application Login

#### Application Login

##### Login information

Fill in your registered e-mail address and password to log in.

##### Don't have an account?

If you don't have an account, create a new one. Click on [Don't have an account?](#)

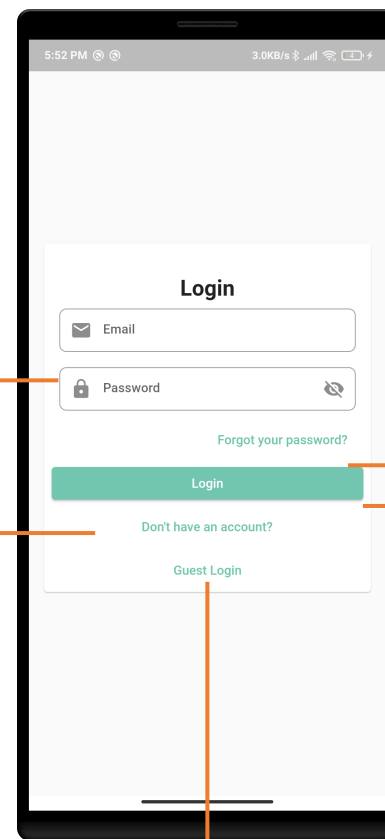

##### Forgot your password?

Click on [Forgot your password](#) to reset your password.

##### Login

After entering all your information, click on [Login](#) button.

##### Guest Login

You can use and review the application without an account.



# 1.

## Application Login

### 1.3 Application Registration

## Application Registration

To register, you must fill out the information below. Your e-mail address and password are for logging into your account again. You will need the wristband for armband ID information. Each armband has a different device ID. By registering to the application, you accept the Terms of Service and Privacy Policy.

### Registration Information

Enter your name, surname, phone number, e-mail, password to register. By registering to the application, you accept the Terms of Service and Privacy Policy. Click on the text to review the Terms of Service and Privacy Policy.

### Register

After filling all your information completely, click the [Register](#) button to register.

7:55 AM 0.0KB/s

### Register

Name

Surname

Phone

Email

Password

☐ Accept the [Terms of Service](#) and [Privacy Policy](#)

Register

[Do you already have an account?](#)

### Do You Already Have an Account?

Click if you have an account. You will be taken to the Sign In screen.

1.

# Application Login

1.4

## Application Registration

### App SMS and Call Permissions

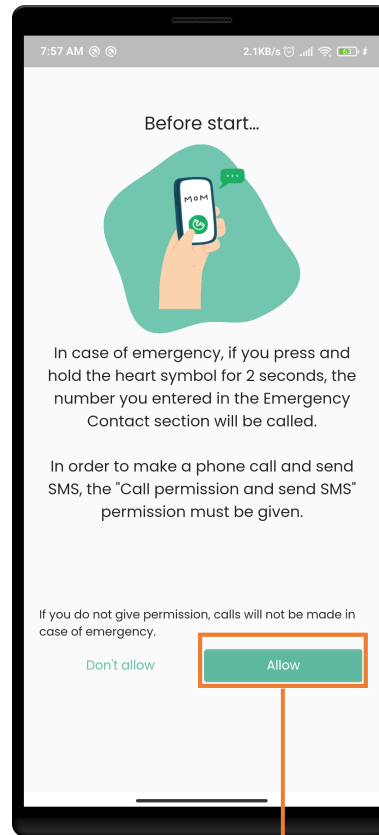

**Allow SMS and calls to be managed to inform your contacts in emergency epileptic situations.**

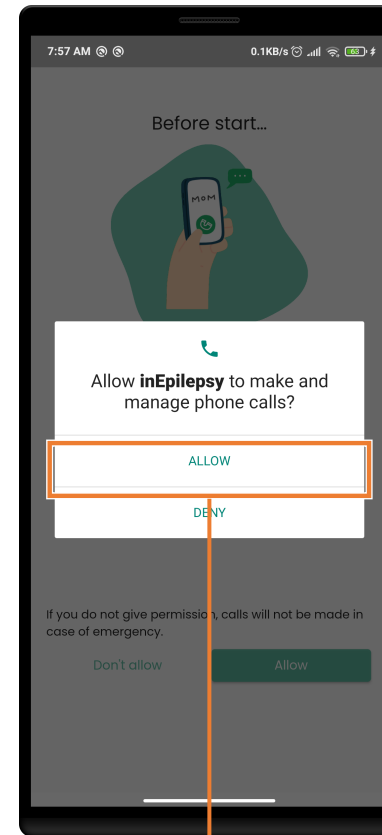

**Let the app make and manage calls.**

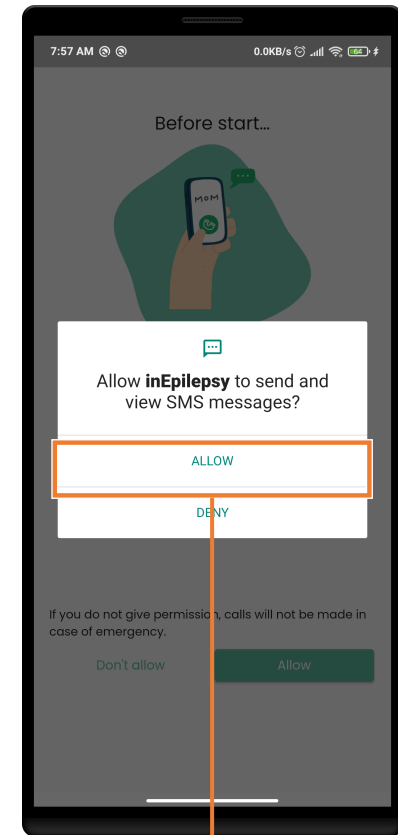

**Allow the app to send and view SMS messages.**

1.

# Application Login

## 1.4 App Permissions (Continue)

## App Battery Restrict Permissions

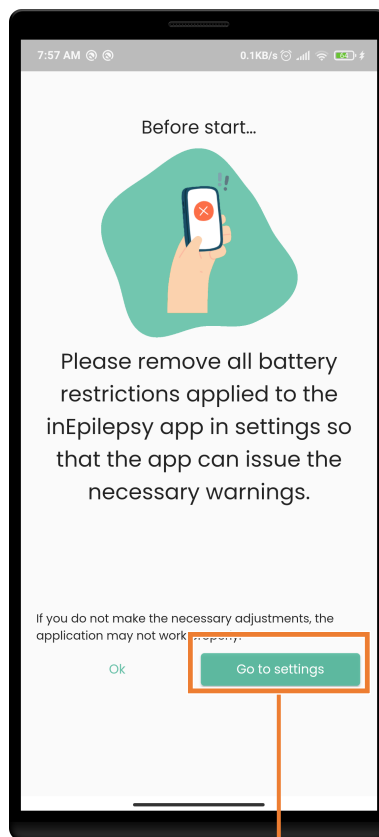

For the application to work efficiently, battery restrictions must be removed. For this Click on [Go to settings](#) button.

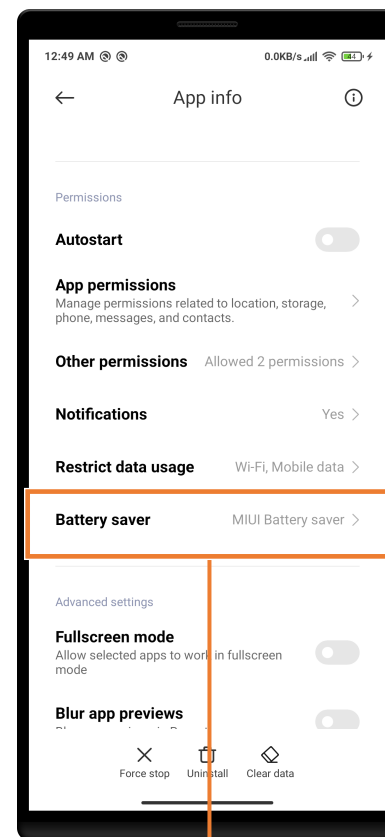

Find the [Battery saver](#) option from the App Information page and click on it.

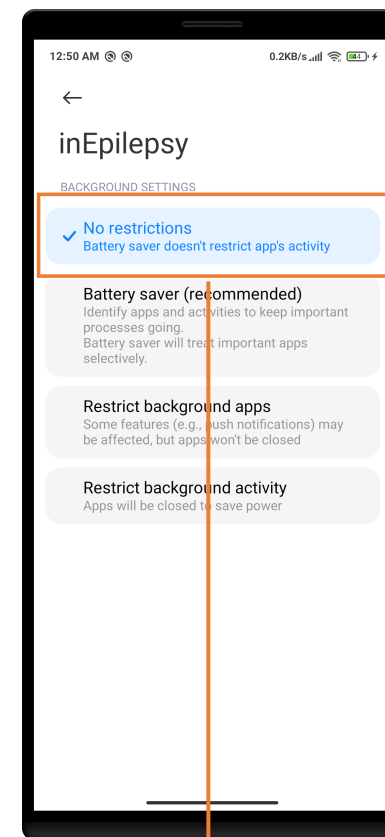

Select [No Restrictions](#) to remove the app's battery restrictions.

# 1.

## Application Install

### 1.4 App Permissions (Coutine)

## About the App

This app is developed for epilepsy patients. In order to give you the most accurate results, the application, which works with an artificial intelligence-based algorithm, is designed to produce more successful results as you use it. You can tick the [Don't show again](#) box to never see this screen again. Click [OK](#) and continue.

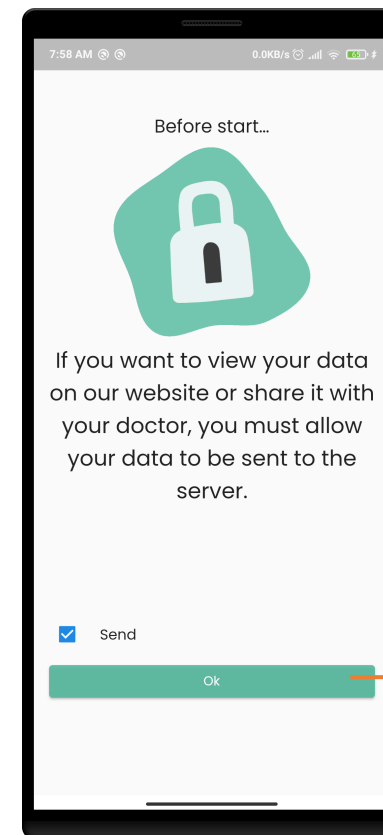
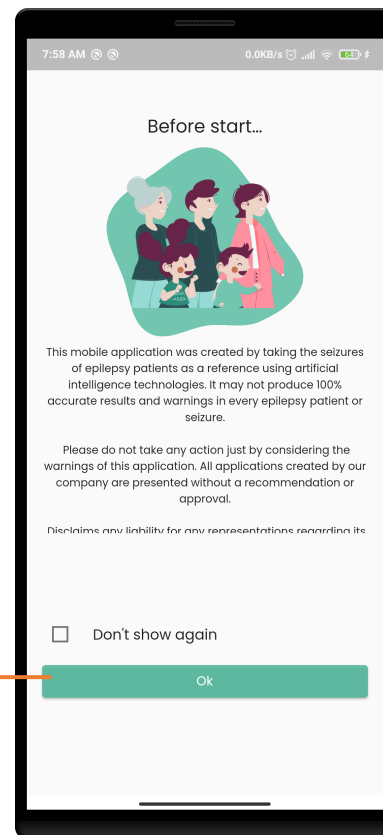

In order to view your recorded data on our website or to share it with your doctor while using the application, you must allow your data to be sent to the server. To do this, check the [Send](#) box and click [OK](#) to continue.

1.

# Application Install

## 1.4 App Permissions (Continue)

### App Permissions

In order to be able to send information about your location to your contacts in emergency epileptic situations, the application must access your location. To do this, click the [Ask permission](#) button.

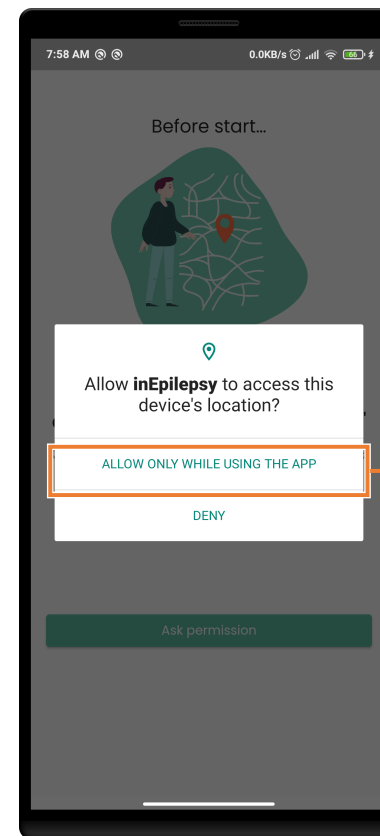
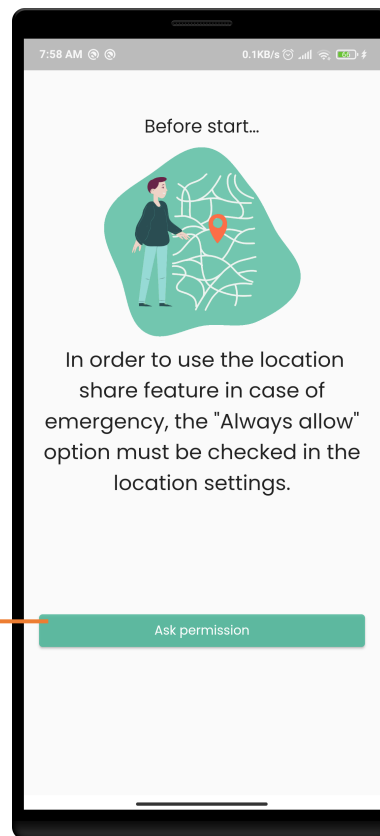

If there is an option to 'Always allow' so that the app can access your location, select it. Otherwise, continue with [Allow only while using the app](#).

1.

# Application Install

1.4  
App Permissions  
(Continue)

## Application Install

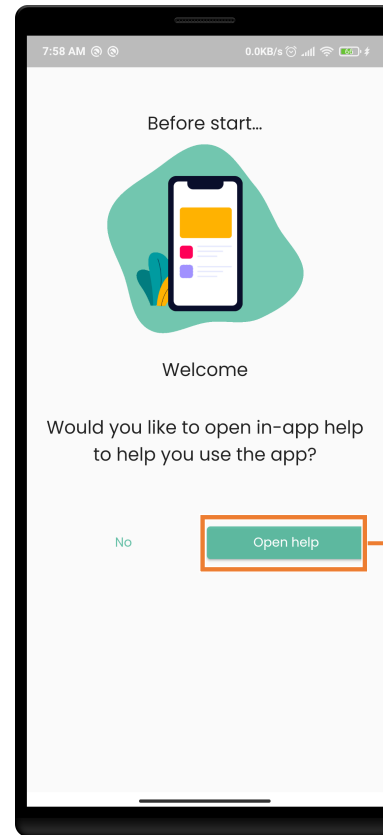

### Open Help

You are now ready to use the application. In-app help to help you use the application will show you small messages on the screen about usage. To do this, click the [Open Help](#) button. If you don't want to see the in-app help, you can press No to continue.

## 2.

# Home Page

### 2.1

## Connecting the Device via Bluetooth

### Pairing the Armband with the App via Bluetooth

After downloading the application, you will see that the heart on the screen is gray. It shows you that the armband isn't connected. Before you start using the application on this screen, you need to connect the armband with bluetooth. For this, keep the armband close to you. Don't forget to charge the armband before using it.

1

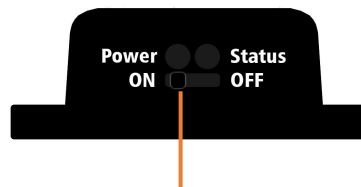

Turn on the armband so that the app can pair with the Bluetooth.(ON)

2

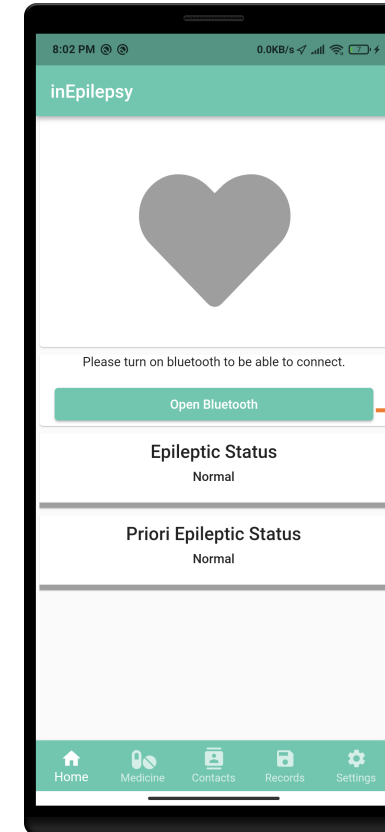

### Turn on Bluetooth

Click to open your phone's bluetooth data.

## 2.

# Home Page

### 2.1

## Connecting the Device via Bluetooth (Countine)

## Pairing the armband with the App via Bluetooth

To connect the armband, you must first turn on your phone's bluetooth data. Then match the app with the data that matches the code on the back of the armband.

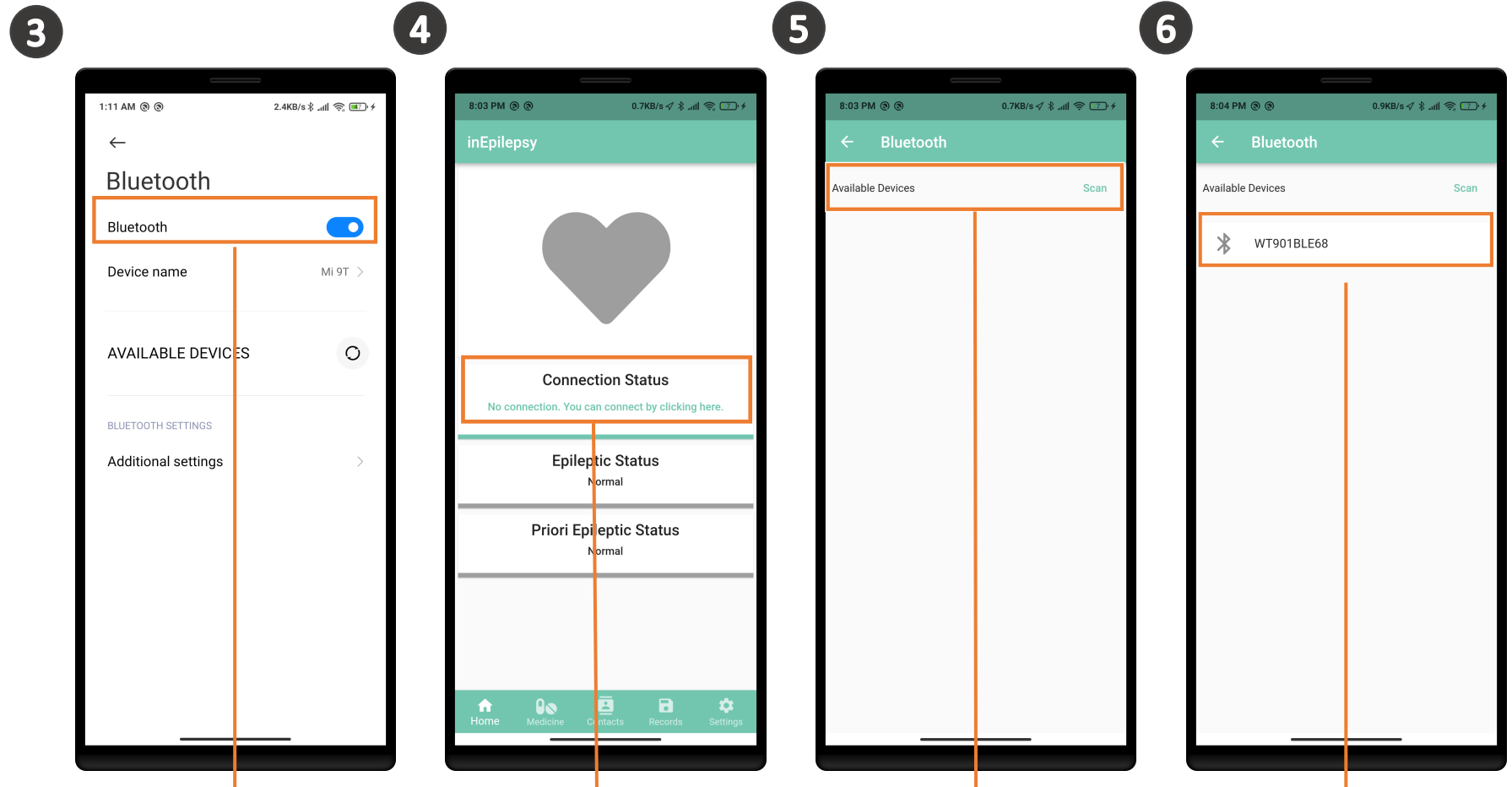

Turn on your phone's bluetooth data.

There is currently no connection between the armband and the app. Click here to connect the armband.

Click on [Scan](#) to find the appropriate device.

Select the data that matches the code written under the barcode on the back of the armband.



2.

# Home Page

2.2

Overview

## Home Page

You can understand that the connection between the armband and the application is established by the green heart on the screen. By connecting the armband, different features will appear on the screen. Here you can monitor the battery status of the armband or disconnect the armband.

### Active

Shows the connection status between the armband and the app. You can disconnect the armband from the application by clicking here.

### Battery

Provides information about the battery status of the armband.

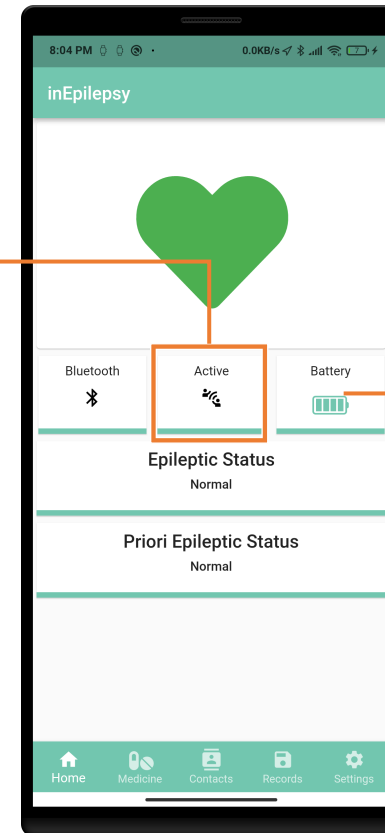

## 2.

# Home Page

## 2.2 Overview (Countine)

### Home Page

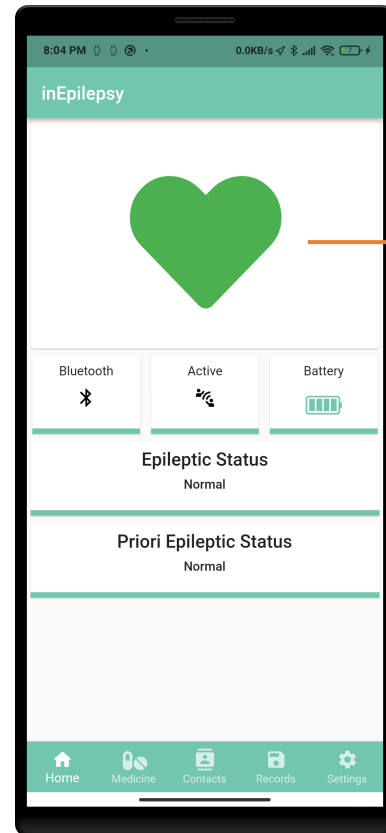

This is the first screen to greet you in the app. The heart icon informs you about your epileptic condition and changes color according to their status.

In addition, if you press and hold on it for two seconds, your contacts will be searched. In this way, it will enable you to reach your contacts in the fastest way in case of a seizure warning you have received beforehand. For this, first of all, do not forget to add at least one of your contacts on the Contacts page.



If the heart symbol is gray, it indicates that there is no connection with the band. In



If the heart symbol is green, it means that you are in good condition.



If the heart symbol is orange, it indicates that you have an Priori Epileptic Seizure.



If the heart symbol is red, it indicates that you have an Epileptic Seizure.

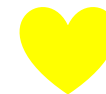

If the heart symbol is yellow, it indicates that you have an Non-Epileptic Seizure.

2.

# Home Page

2.2  
Overview  
(Countine)

## Home Page

In any epileptic condition, you will receive an audible alert. This screen will inform you about your epileptic status during any seizure.

### Warning

It is a warning notification in any epileptic condition. Information about your epileptic status is displayed here.

### Seizure Type

There are two types of seizures. Epileptic and non-epileptic. Here you will learn about the seizure you had.

### Epileptic Condition

Your epileptic state may change to normal or seizure.

### Priori Epileptic Condition

A prior epileptic state notifies you that an expected seizure is about to occur. Otherwise, your status is reported as normal.

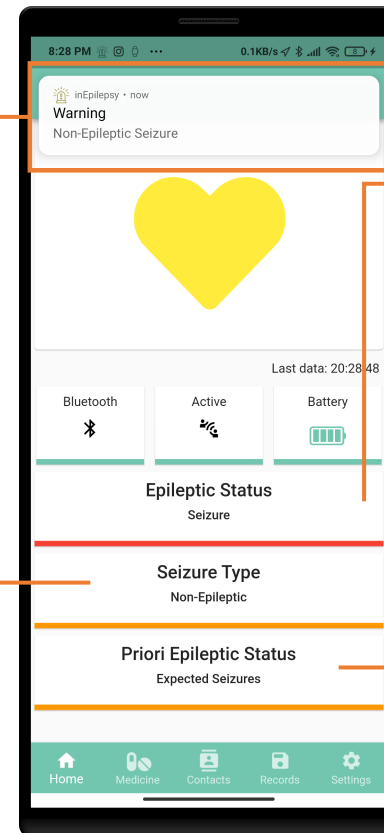

## 2. Home Page

### 2.3 Navigation Tab Bar

#### Navigation Tab Bar

##### Home

It is the first screen that greet you in the applicationThis is the screen that displays your epileptic status.

##### Contacts

This is where your contacts can be reached in an emergency. You can add and delete contacts.

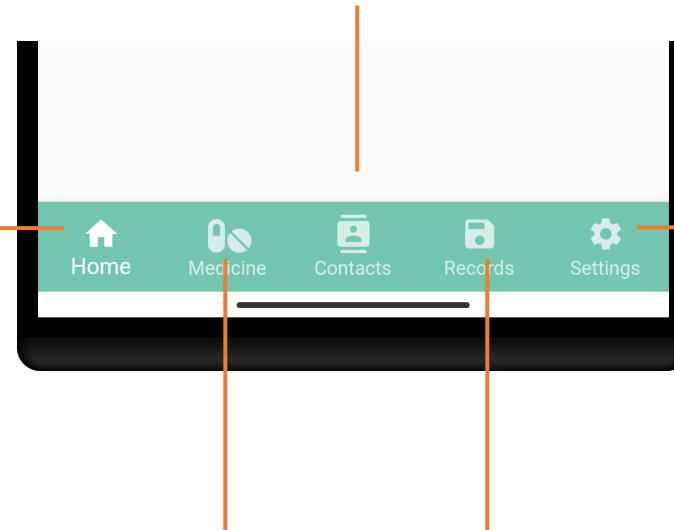

##### Settings

This is where you manage all the settings within the app. You can also share your data with the doctor by choosing a doctor here.

##### Medicine

By setting a reminder time for the medicines you use, you can receive notifications at the time of the medicine. Here you can add, delete and view your medication history.

##### Records

This is where all your epileptic states are recorded. You can add a crisis situation by selecting the start and end time.

# 3.

## Medication Reminder

### 3.1 Overview

### Medication Reminder

With this application, you can keep track of the medicines you use. Add the medicines you use for this. After adjusting the time and dose of your medications, you will be warned at the time of taking the medication. In this way, problems such as unnecessary medicine use and forgetting to take medicines will be prevented. You can also see all your past medicine use.

#### Medicines

You can find the list of all medicines you have added here. You can see and edit the medicine usage details when you click on the medicine.

#### Add Medication Button

You can add medication by clicking here.

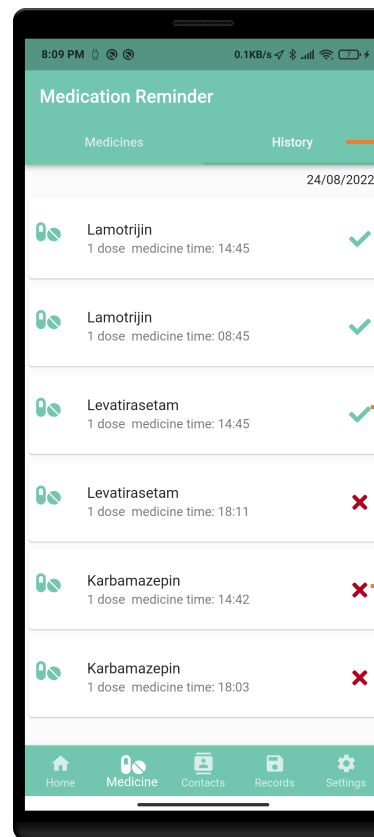
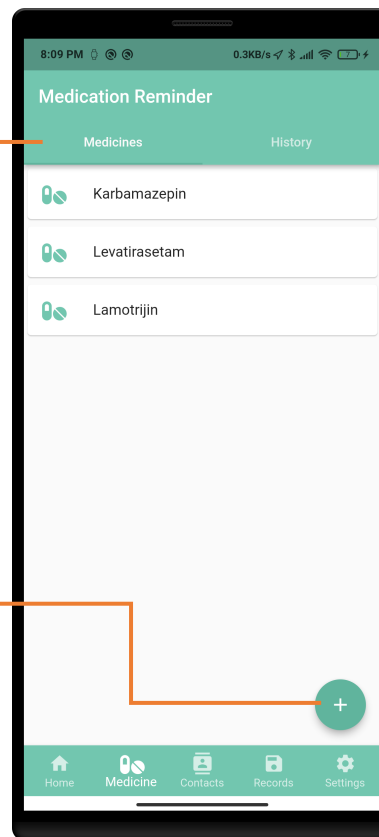

#### Medication Use History

Here you can find a list of all your past medicines use.

#### Medicine Use Status Used

#### Medicine Use Status Unused

3.

# Medication Reminder

3.2

## Adding Medication

### Adding Medication

#### Medication List

When you click here, a list of medicines will appear. Here you can add the medications you want to be reminded of. You can also find the medicine to add faster by searching.

#### Adding Reminder Time

When you click here, select a specific time to remind you of the medication use time.

#### Save

Tüm seçimleri yaptıktan sonra [Kaydet](#) butonuna tıklayın.

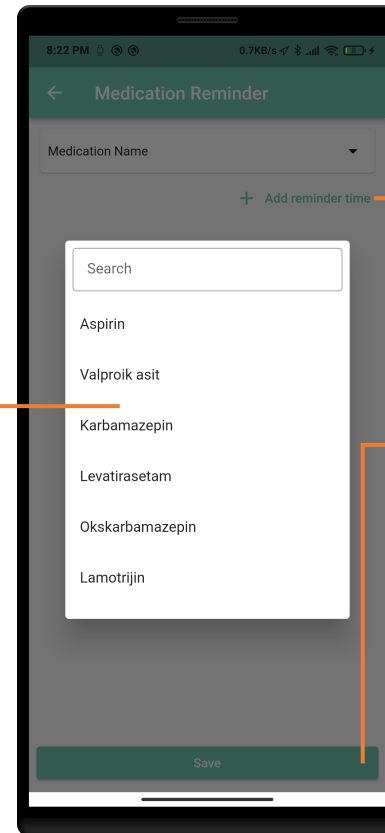

3.

# Medication Reminder

## 3.3 Medicine Update

### Medicine Update

To change the reminder time of the medicine you have added, you can click on it and select a new time.

You can click on the medicine dose and change the number of doses.

Click on [Update](#) button to save all the changes you have made.

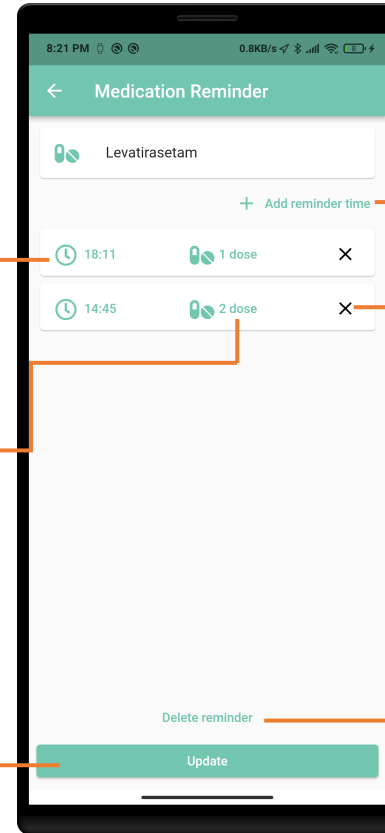

You can add more than one reminder time to the medication you add.

You can delete the reminder time by clicking the X.

To remove the reminder for this medicine completely, click on [Delete reminder](#).

# 4. Contacts

## 4.1 Overview

### Contacts

Contacts of patients are the people who will be notified of your situation and location in a crisis via SMS and call. Alerts to your contacts will prevent bad situations that may occur in advance. This screen is where your patient contacts are listed and added. There is no limit to add a patient contact.

#### Patient Contacts

All patient contacts you have registered are listed on this screen.

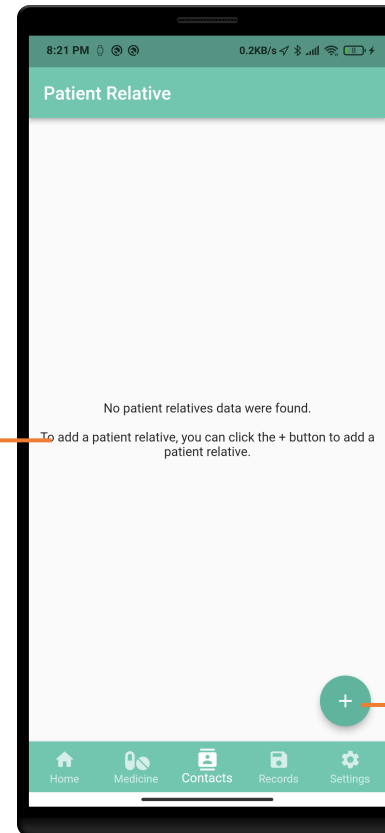

**Adding a Patient Contact**  
When you click here, the patient addition screen opens.



# 4.

## Contacts

### 4.2

#### Adding Patient Relative

### Adding Patient Contact

It is very important that you enter the correct phone number when adding patient relatives information. Phone numbers should be formatted in international format (+ then country code, then number). If entered correctly, this person will not receive phone calls or SMS messages in case of a seizure alert. Example usage for Turkey: +905XXXXXXXXX

#### Patient Contact Information

Enter the name, surname and phone number of the patient's relative you will register.

9:07 PM 2.8KB/s

← Contacts

Name of patient's relative

Surname of patient's relative

Phone of patient's relative

Adding someone as a relative of the patient allows you to send an alert via SMS in case of a crisis.

Add patient relative

#### Add Patient Relative

Finally, click the [Add patient relative](#) button to add the patient relative.

# 5.

## Records

### 5.1 Overview

## Records

All of your epileptic states that occur are recorded. Epileptic status records will give you information about the start and end time of the seizure that has passed. Sharing these records with your doctor will help them learn better about your condition. You can find the record of all your recorded epileptic states here.

### Records

All of your recorded epileptic states are listed here. You can also select the epileptic condition you want listed.

### Incorrect

You can incorrect report a recorded epileptic condition that you think is false by clicking on it.

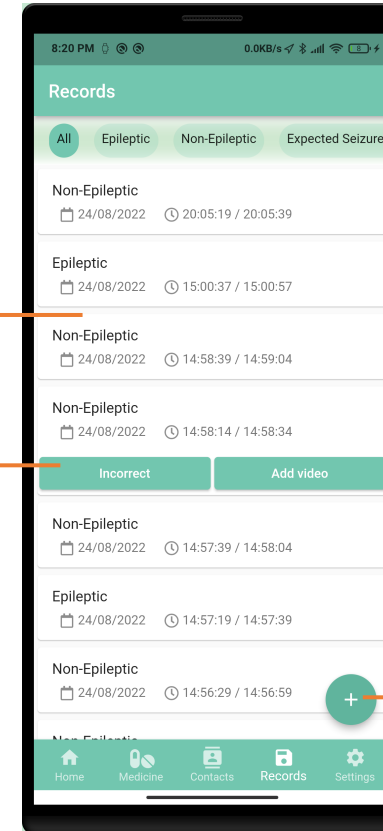

Epileptic

Non-Epileptic

Expected  
Seizures

Manuel

There are 3 different epileptic conditions. Epileptic, Non-Epileptic and Expected Seizures. Manual are epileptic records that you add.

### Add

You can manually add an epileptic condition here.

# 5.

## Records

### 5.2

#### Adding Crisis

#### Adding Crisis

##### Start Time

Select the start time of the crisis to save.

Indicate here whether you are having an Epileptic or Non-Epileptic Seizure.

##### Save

Click on [Save](#) button to save a crisis situation.

8:19 PM 1.8KB/s

← Add seizure

Start time End time

Epileptic

Add video

Save

##### End Time

Select the end time of the crisis to save.

##### Add Video

If you have captured the moment of crisis on camera, you can add it and share it with your doctor. To do this, click on [Add video](#) button and select to add the video of the crisis moment.

# 6.

## Settings

### 6.1 Overview

## Settings

The Settings screen is where you manage all app settings.

### User information

Your personal information is displayed here. You can edit your personal information by clicking on it.

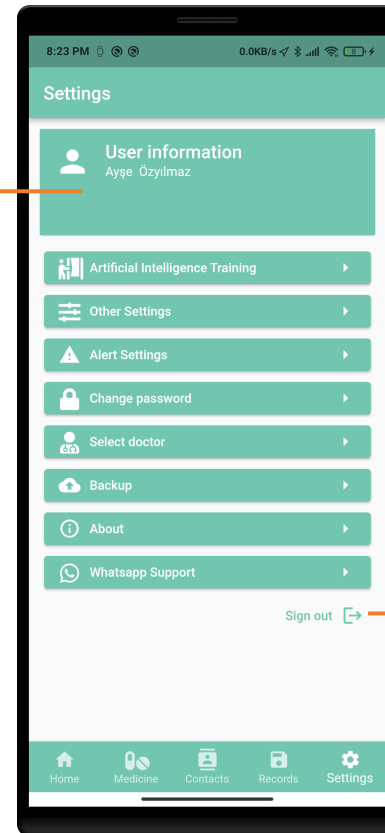

### Sign Out

Click on [Sign out](#) to end your session from the application.

6.

# Settings

6.1  
Overview  
(Countine)

## Settings

### Artificial Intelligence Training

You can retrain your AI model, revert to your previous model or switch to the default model.

### Alert Settings

You can update the sound levels and notification statuses of alert situations.

### Select Doctor

You can choose your doctor by clicking here.

### Whatsapp Support

You can us via whatsapp by clicking here.

### Other Settings

You can update the sensivity setting of the armband here and update the preference of sending data to the server.

### Change Password

By clicking here you can change your password.

### Backup

You can backup or send your data by clicking here.

### About

You can see view the About, Privacy Policy and Terms & Conditions.

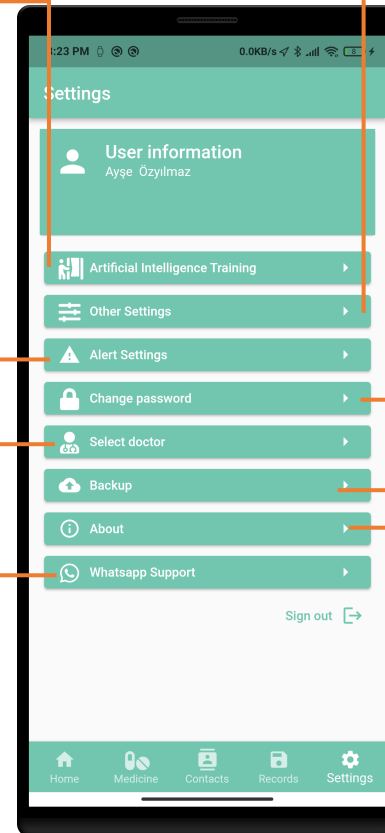

## 6.

# Settings

### 6.2

## Artificial Intelligence Training

## Artificial Intelligence Training

### Train Artificial Intelligence

You can create a new artificial intelligence model with a higher success rate by sending your recorded data to training while using the application. To do this, agree to submit your data by clicking on it. Also, train the AI after reporting the recorded data you find faulty. It will give you more accurate results.

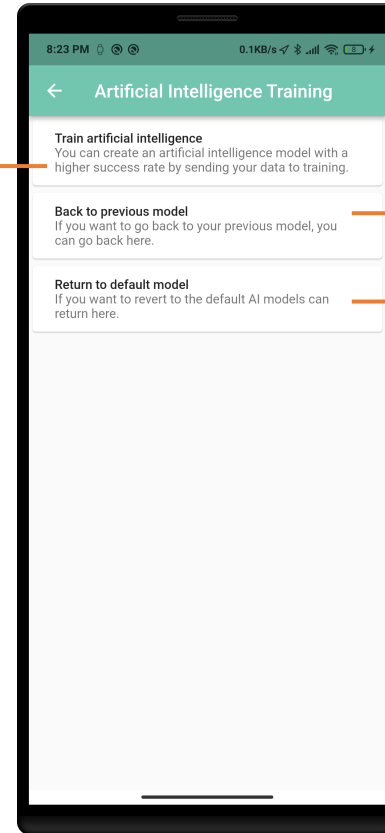

### Back to Previous Model

If you want to return to your old artificial intelligence model after sending your data to training, you can click on it and agree to switch to your previous model.

### Return to Default Model

If you want to return to the default model after the changes you have made with the artificial intelligence model, you can return here.

# 6. Settings

## 6.3 Other Settings

### Other Settings

#### Other Settings

Sensitivity levels change the patient's seizure detection status. For example, if hypersensitive is selected, the seizure is detected earlier. If it is less sensitive, the seizure detection situation will be a little later.

#### Reset In-App Help

The in-app help display shows you onscreen small messages about using the app. It only does this once. Resetting this status will show the in-app help again. To do this, click on the text.

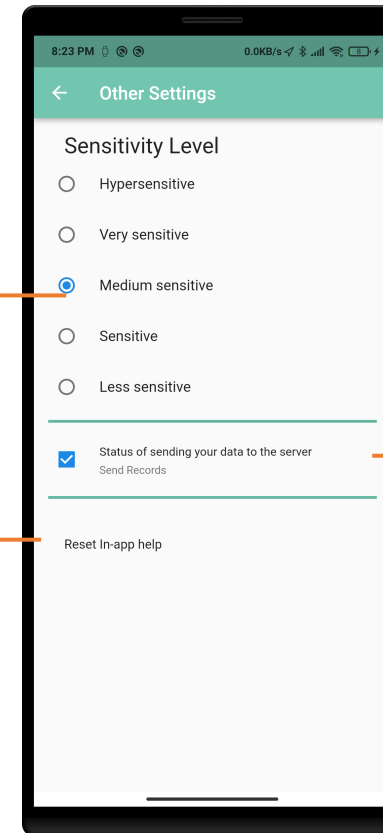

#### Status of Sending Data to Server

Before you can view your data on our website or share it with your doctor, you must agree to send data to the server. You can change your data sending status to the server by ticking the box here.

# 6. Settings

## 6.4 Alert Settings

### Alert Settings

#### Warning Volume

In cases of epileptic seizures, you can change the volume of the warning that will come to you here.

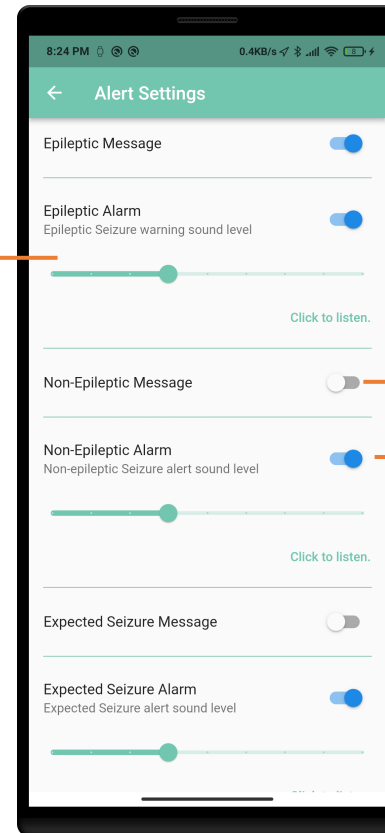

#### Seizure Warning Message

Here you can change which watch situations the relative of the user is informed by SMS.

#### Seizure Alarm

Seizure alarms will give you an audible alert in any epileptic condition. From here you can turn the sound alert on or off.



6.

# Settings

6.5

Change Password

## Change Password

To change your current password, first enter your old password. Then enter the new password you set.

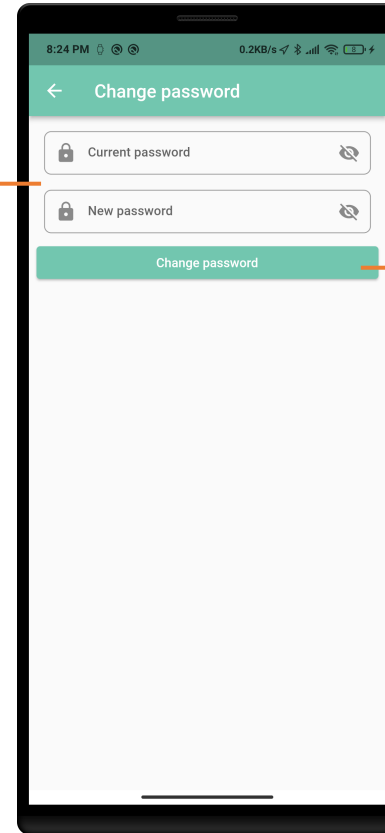

Click on [Change Password](#) button to save your new password.

6.

# Settings

6.6

Select Doctor

## Select Doctor

### Doctor List

You can choose from the doctors listed here to share your data with your doctor.

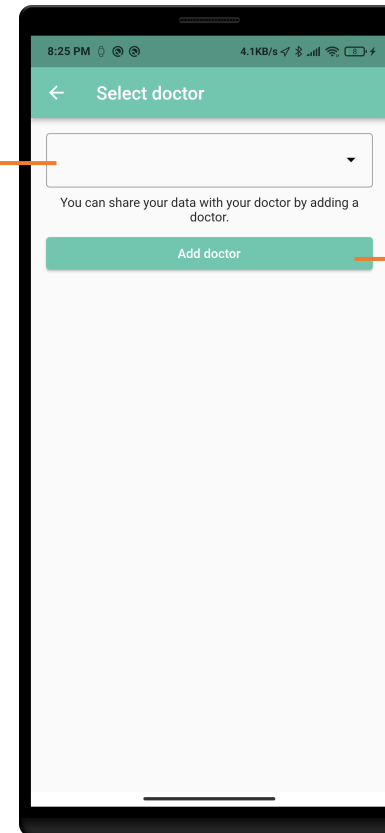

### Add Doctor

Finally, click the [Add doctor](#) button to save your doctor selection.

## 6.

# Settings

### 6.7 Backup

## Backup

All epileptic situations that occur are recorded within the application. You can upload or share this data.

### Backup

You can back up your data for later sharing.

### Backup and Send

You can use this option to backup and share your data at the same time.

### Send

You can use this option to share your backed up data.

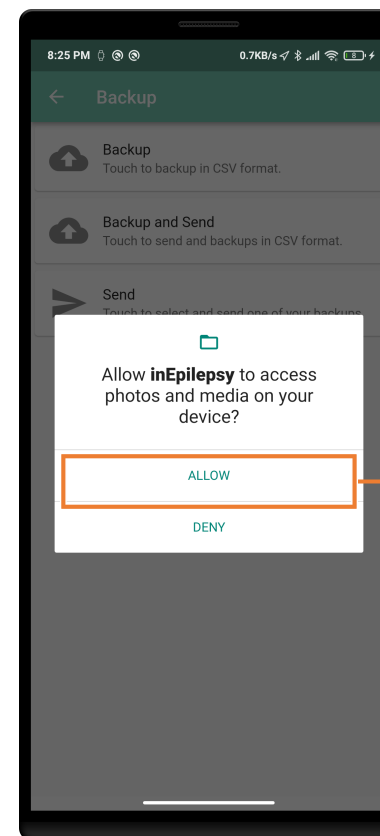
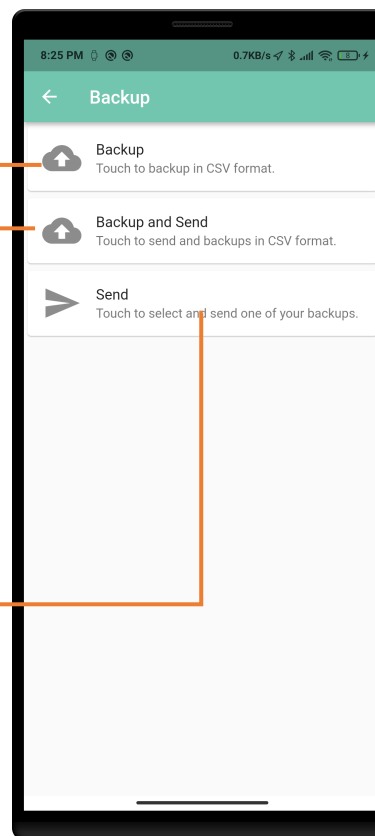

### Permission to Access Files

To share your backed up data, the app needs access to the files on your device. Select [Allow](#) for this.

6.

# Ayarlar

6.8

About the App

## About the App

### Contact Us

Here you can send an e-mail and contact us for help and all your opinions.

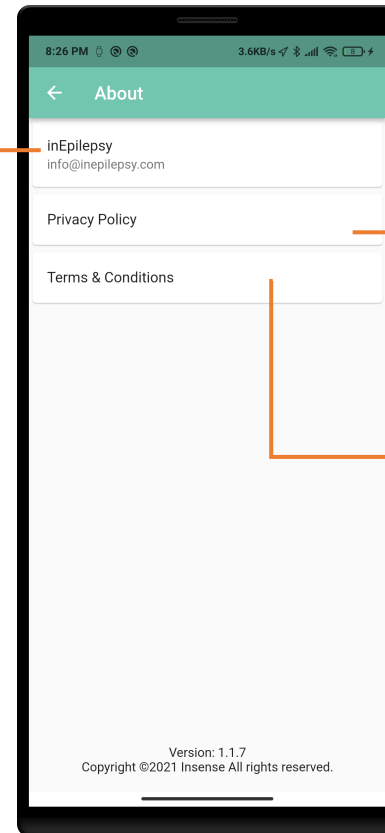

### Privacy Policy

You can review the Privacy Policy about the application here.

### Terms & Conditions

You can learn about the Terms & Conditions of the application here.

6.

## Settings

6.9

Whatsapp Support

### Whatsapp Support

You can contact us for your problems and suggestions at any time from our Whatsapp Support line.

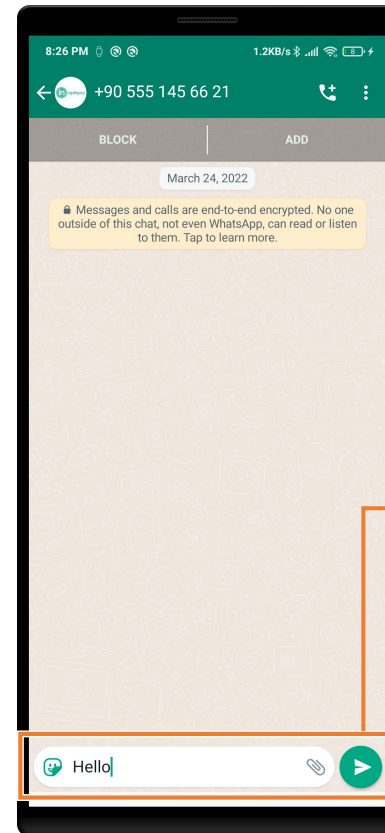

Write and send your message.

# 7.

## Armband

### 7.1 Overview

#### Armband

##### Power

Provides information about the battery status of the armband. When plugged in, the red light turns on.

##### Status

The blue light will flash when the armband is on.

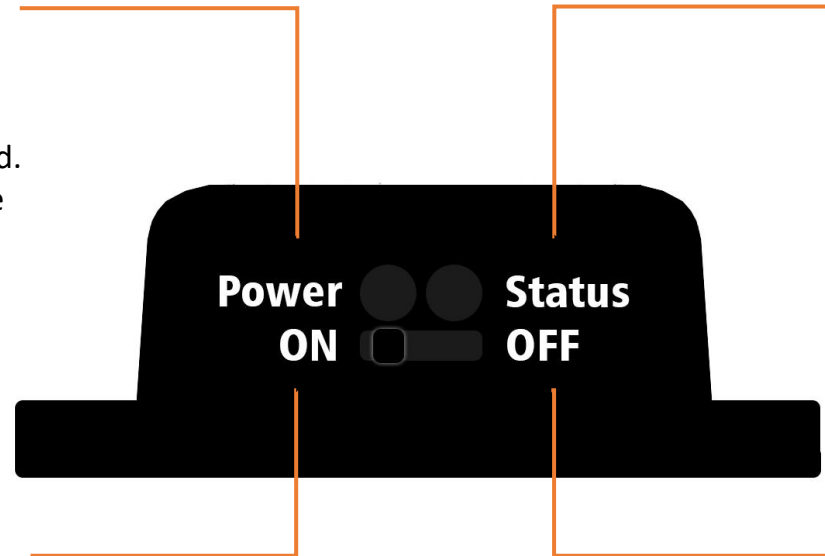

##### on

It is the state where the armband is open.

##### of

It is the case when the armband is closed.

## 8.

### Patient's Contacts

### Help Requests

#### 8.1 Text Messages

### Epileptic Status Message Sent to Your Relatives

At the time of epilepsy seizure, it warns you and your relatives, and it is sent to your relatives with a message containing your location. Your location during the watch will be sent to your relatives as an instant message with a visual map, and your location will be instantly detected.

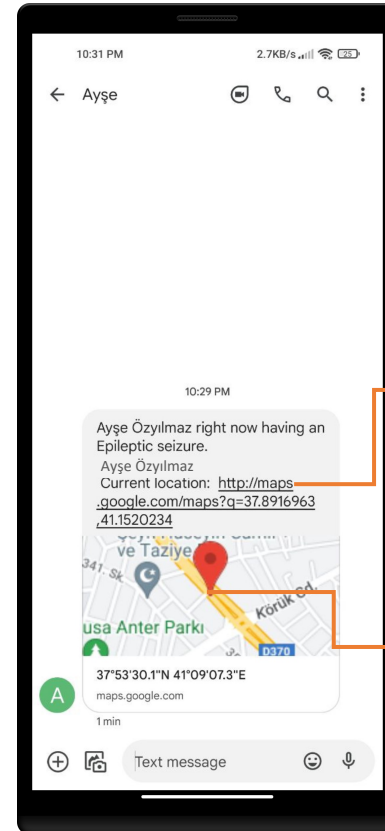

When an epileptic situation occurs, an SMS is sent to your relative with user information, seizure status and location.

You can open the map by clicking here.

8.

## Patient's Contacts

### Help Request

8.2

### Outgoing Call

## Outgoing Call to Relatives in an Emergency Epileptic Situation

180 seconds before the epileptic seizure comes, you and your relatives are warned. Thanks to the warning you received before the seizure; With the emergency call feature in the application, you can quickly call your relatives and report your status.

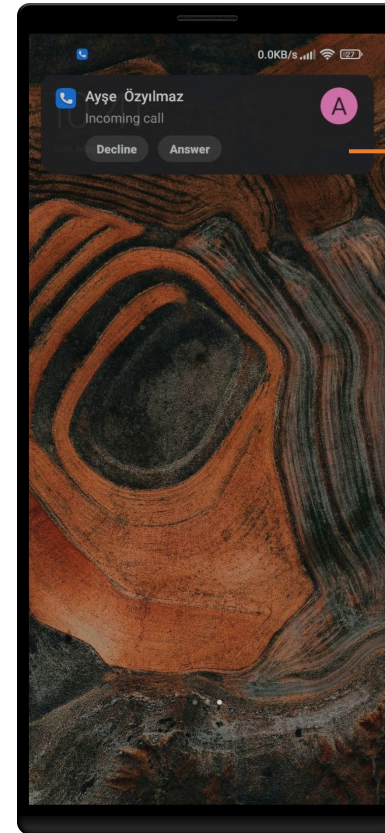

When the call to your relative is answered, you can inform about your situation and prevent bad situations that may occur beforehand.



9.

# Notifications

## 9.1 Epileptic Status

### Epileptic Status Notifications

Before the seizure, a notification will appear on your screen and information will be sent to your relatives. By taking yourself into a safe position with the warning you received before the seizure, you can avoid falling, hitting, etc. protect against risks. Thus, you can get emergency help from people around you and far away.

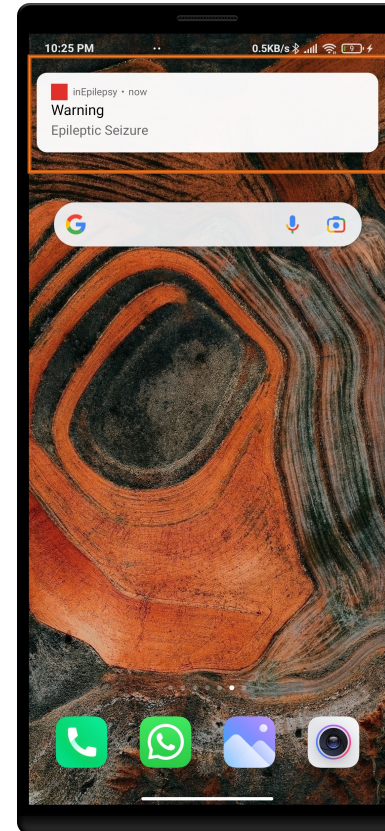

When an epileptic situation occurs, you will be warned with a notification on your screen.

9.

# Notifications

9.2

## Medication Reminder

### In-App Medication Reminder

Reminders in the application allow you to keep track of the medicine you use. You will be warned at the time of taking the medicine by adjusting the time and dose of your medicines. In this way, problems such as unnecessary drug use or forgetting to take medicine will be solved.

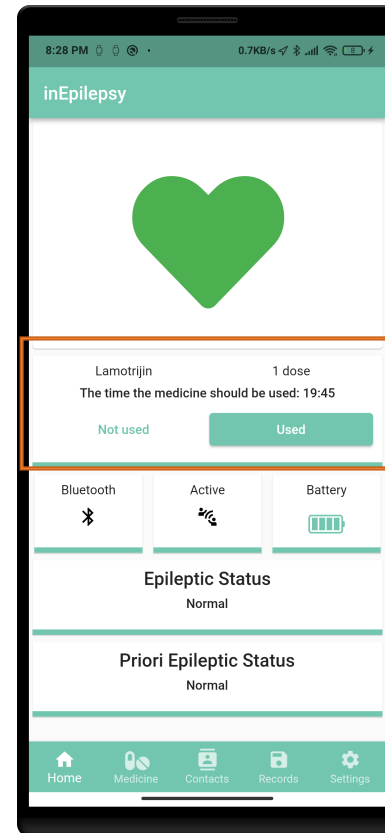

You will see medication reminder notifications on the home page. Here, record the usage status of the medicine as Used or Not Used.

9.

# Notifications

9.3

## Armband Disconnection

### Armband Disconnection

When the connection between the armband and the application occurs, the following warning will appear on your screen. Situations such as being away from the armband or running out of battery may cause a disconnection. For this, first make sure that the armband is turned on. Try connecting again later.

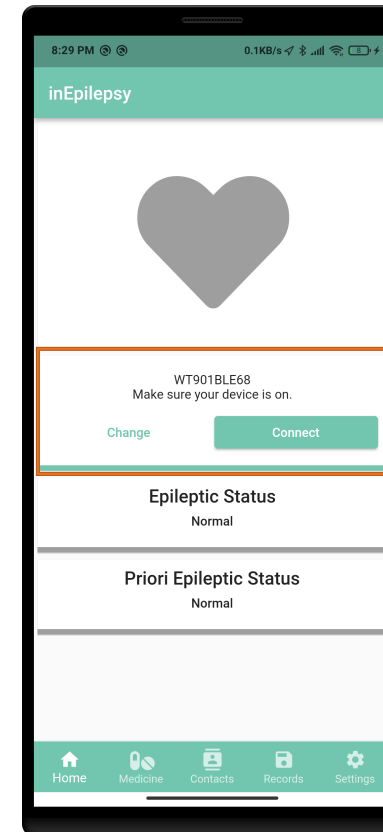

Click the [Connect](#) button to reconnect to the armband. If you are going to link with another armband, click the [Change](#) button.